



This product bears the selective sorting symbol for waste electrical and electronic equipment (WEEE).

This means that this product must be handled pursuant to European Directive 2002/96/EC in order to be recycled or dismantled to minimize its impact on the environment.

For further information, please contact your local or regional authorities.

Electronic products not intended in the selective sorting process are potentially dangerous for the environment and human health due to the presence of hazardous substances.

If faults cannot be remedied, contact the **Helpline** on **020 8391 6767**  
**helpline@hilka.co.uk**

#### **GUARANTEE**

This product is guaranteed for domestic use for a period of 12 months against faulty manufacture or materials. This guarantee does not affect the statutory rights of the consumer. In the event of any problem occurring please contact our Helpline at the number above for advice. This product is not guaranteed for **HIRE** purposes.

**Manufactured under license for:**  
**HILKA PRO IMPORTS**

**1 ROEBUCK PLACE, ROEBUCK ROAD, CHESSINGTON, SURREY KT9 1EU**

# RAC

## RAC-HP101

### 2in1 Pressure Washer with Wet & Dry Vac Assembly Manual

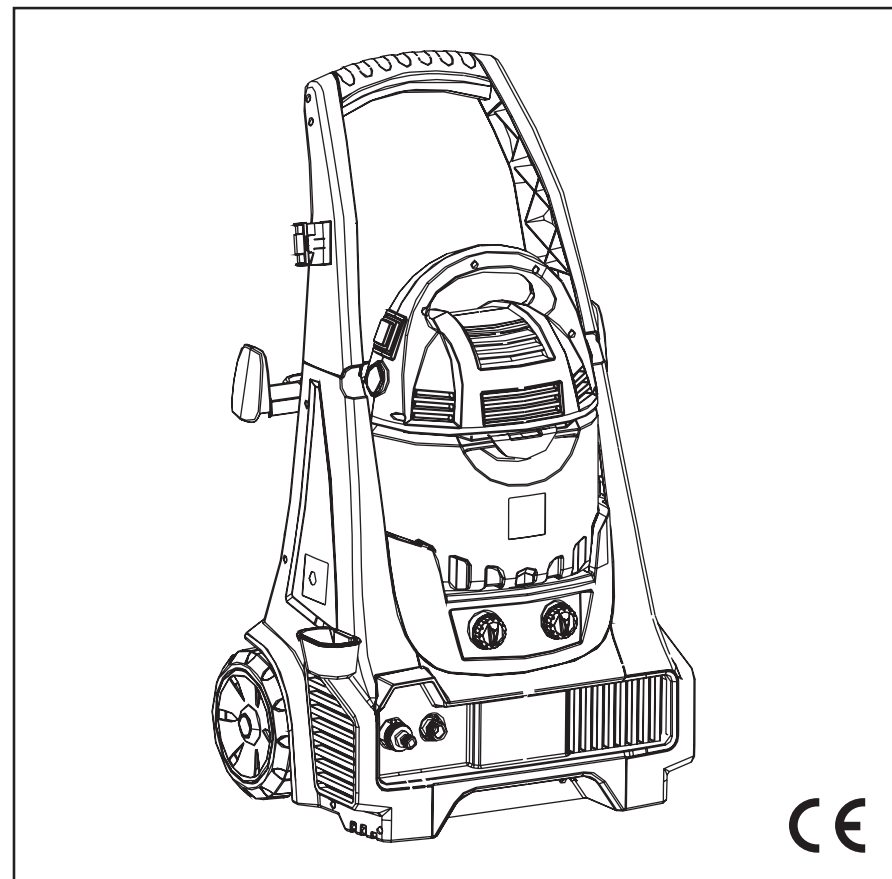

#### **Environmental Protection**



Waste electrical products should not be disposed of with household waste. Please recycle where facilities exist. Check with your local authority or retailer for recycling advice.

## Assembly Instructions

### Shelf Assembly

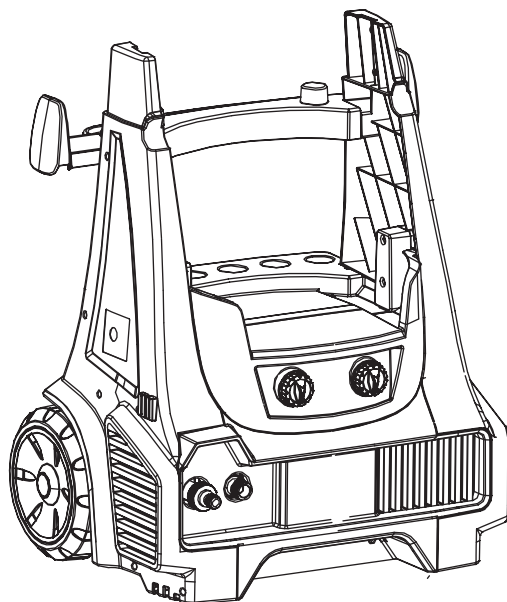
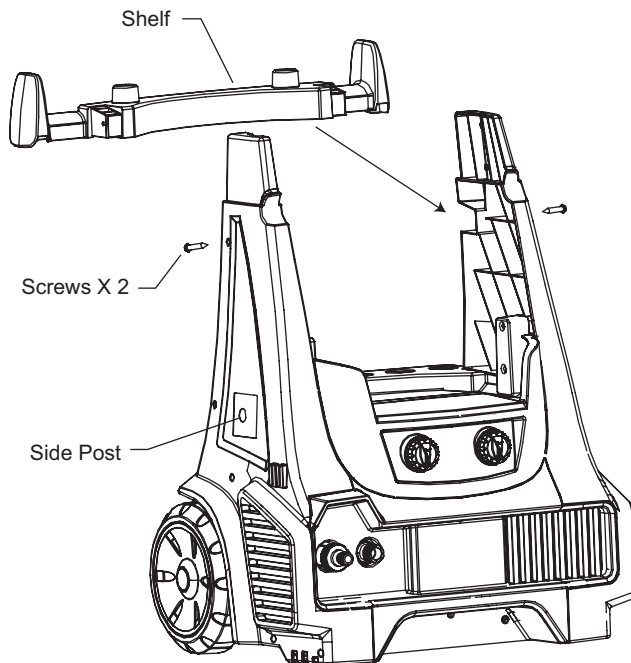

Place the shelf between the side posts and fix using 2 X screws provided

### Handle assembly

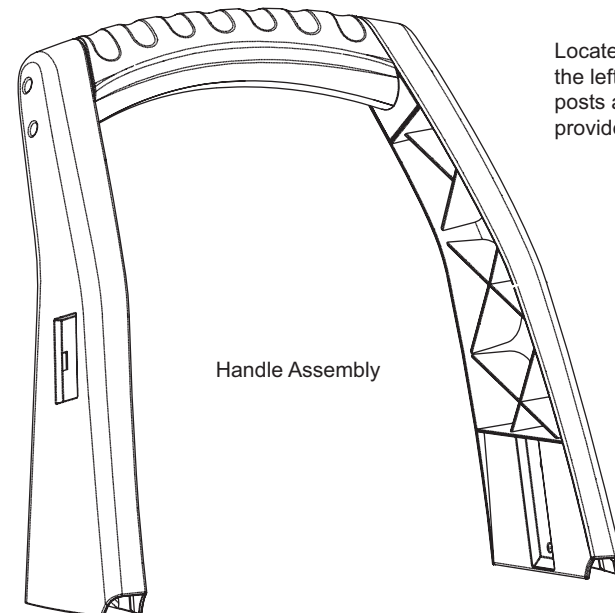
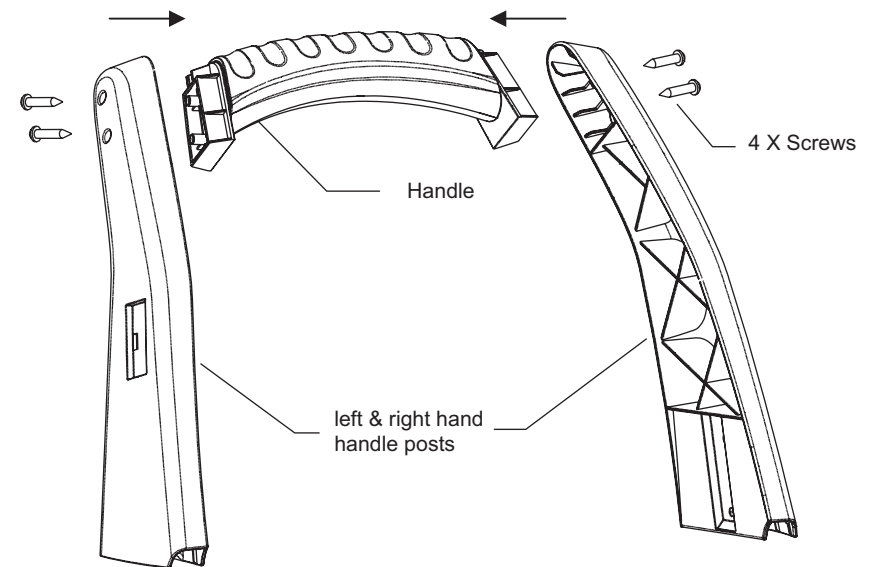

Locate the handle between the left & right hand handle posts and fix with 4 x screws provided.

Handle Assembly

## Handle Assembly to Base

Locate the handle assembly over the side posts and fix with 4 x screws provided.

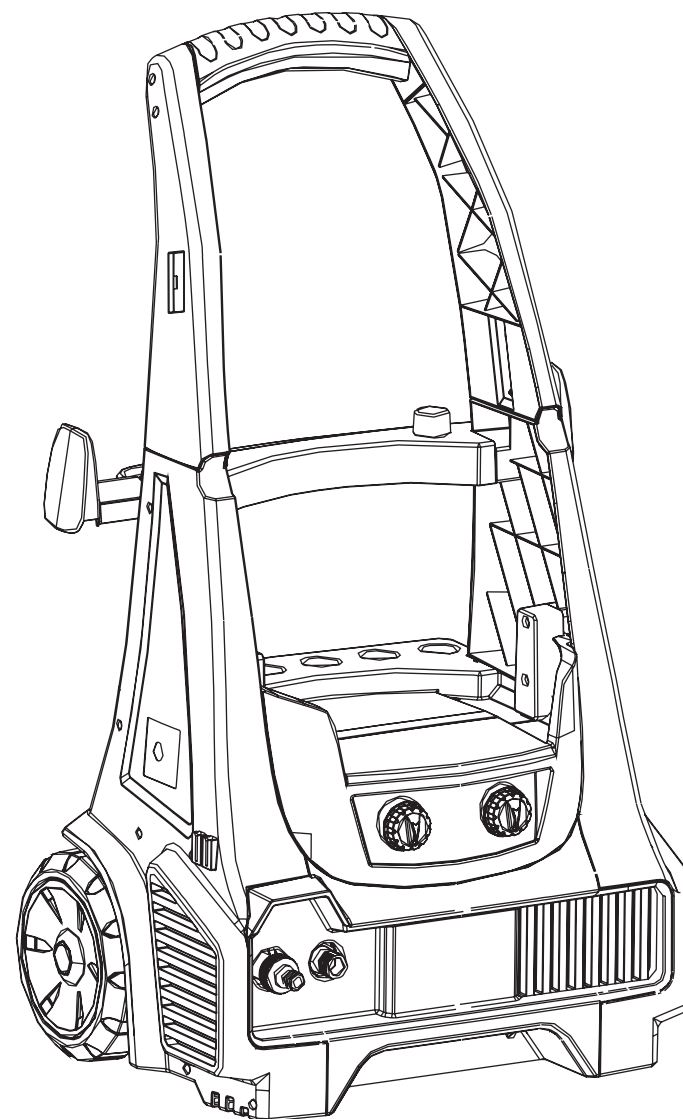
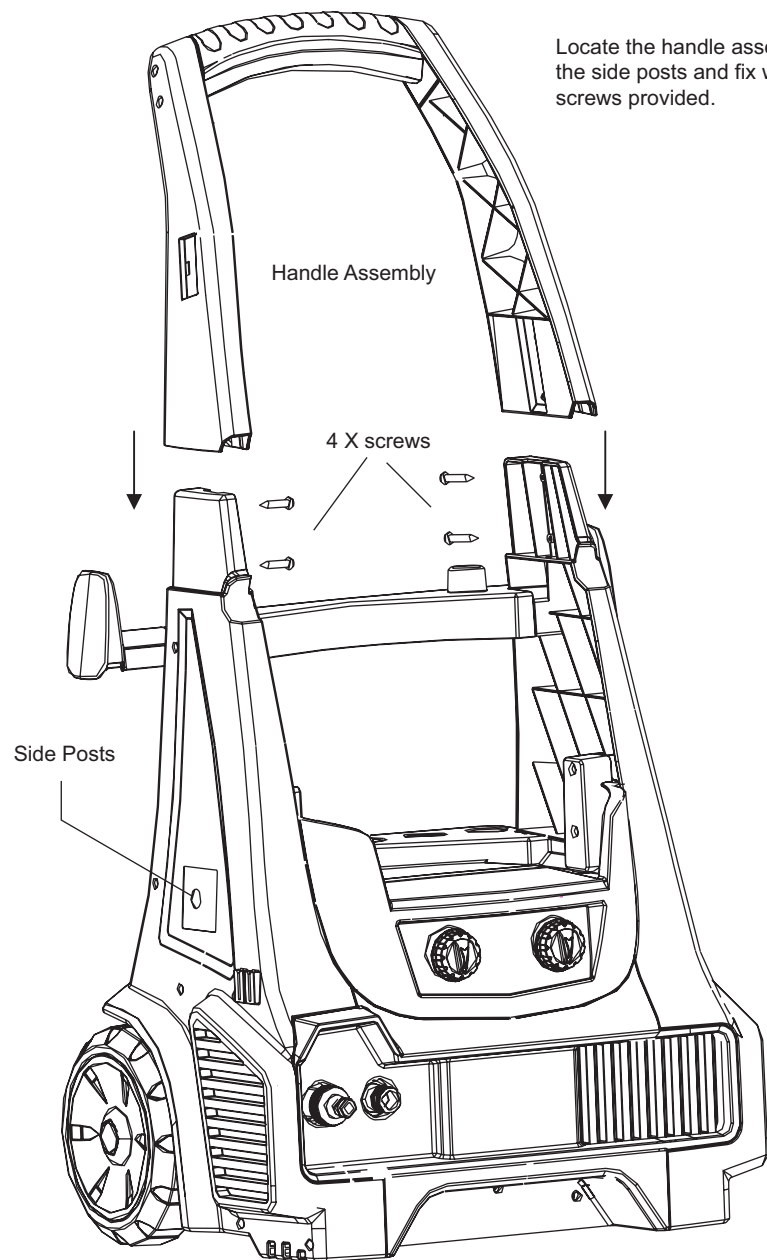

## Upper & Lower gun holder

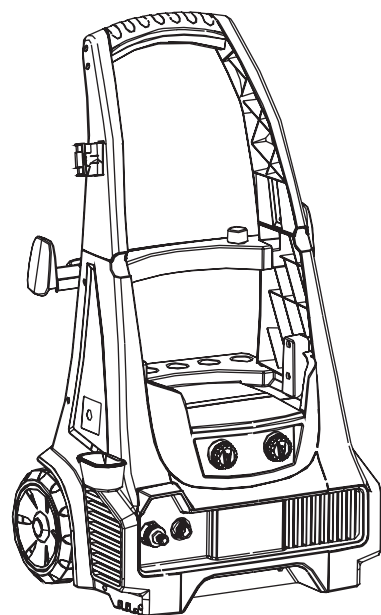
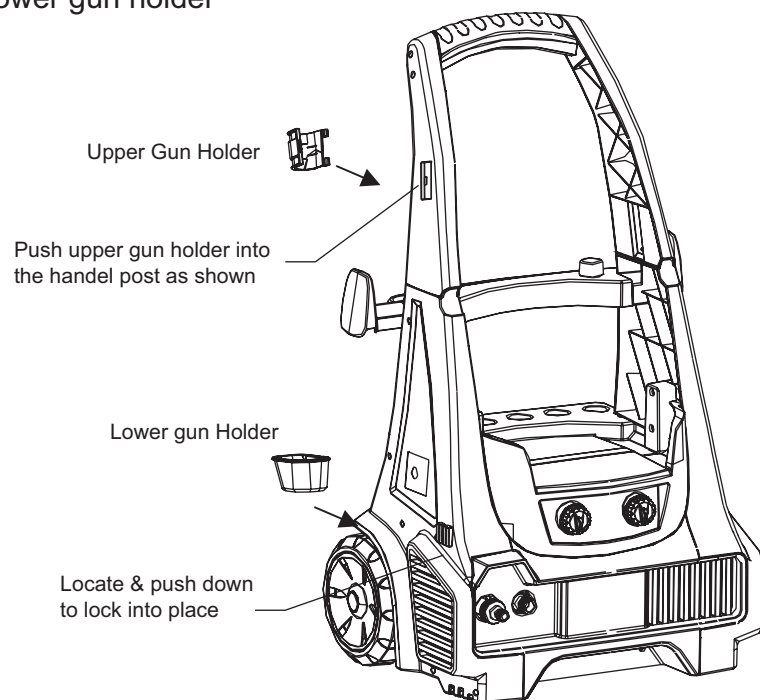

## Vacuum Cleaner Location

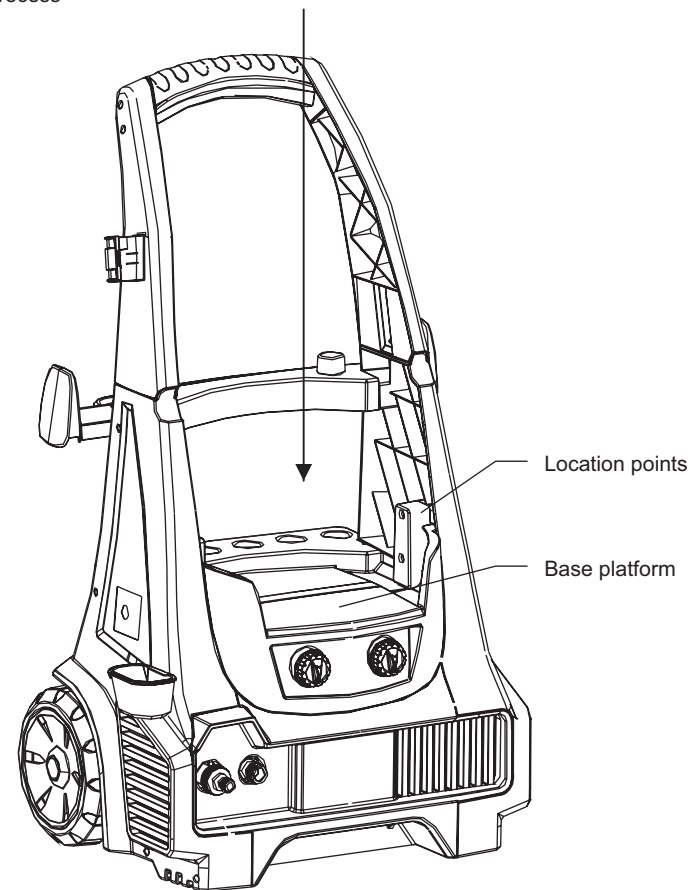
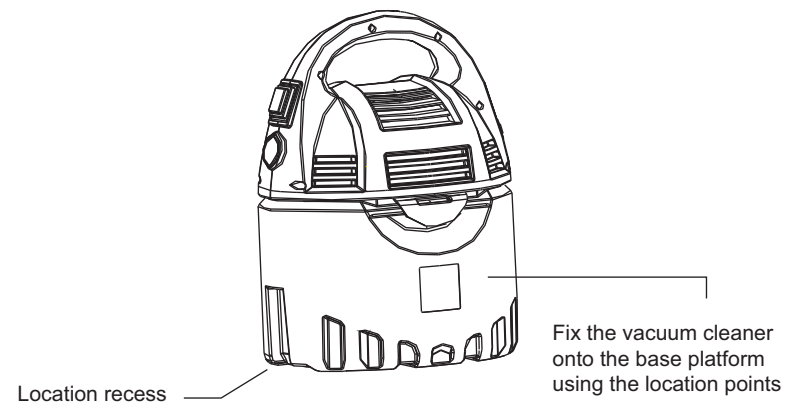

---

Completed Assembly

